

The Barrington

All the space you need, now and in the future



Whether you're planning for a family or expecting your nest to empty in a few years, The Barrington can accommodate your needs. With a first-floor master suite, single-floor living is always a possibility – one made all the more charming by this home's front porch and sociable common area.

But then there's the whole second floor! Two large bedrooms that share a bathroom and loft area can be home base for the kids or serve as a temporary home for weekend guests.

The ability to use just the spacious first floor until more space is needed makes The Barrington an especially flexible design.



www.brookspostandbeam.com

The Barrington

The Rooms

Share stories of your day as you prepare dinner in the common area comprising the kitchen, dining area and living room. On a warm afternoon, enjoy lunch on the deck off the dining area.

The master suite includes a large bathroom and walk-in closet – or, you could use some of this space for the laundry! All just a few steps from the front porch or living room.

The loft is a perfect place for getting homework done, playing computer games or just having a cozy chat.

The large second-floor bedrooms are well-lit and private – everyone can retreat to their own happy place at the end of the day.



The Barrington

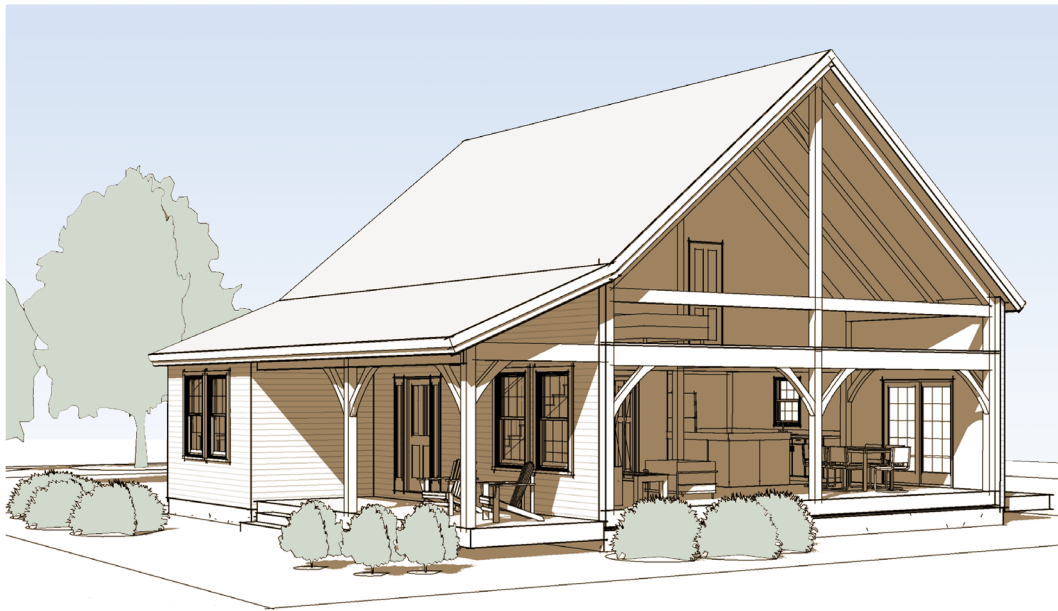
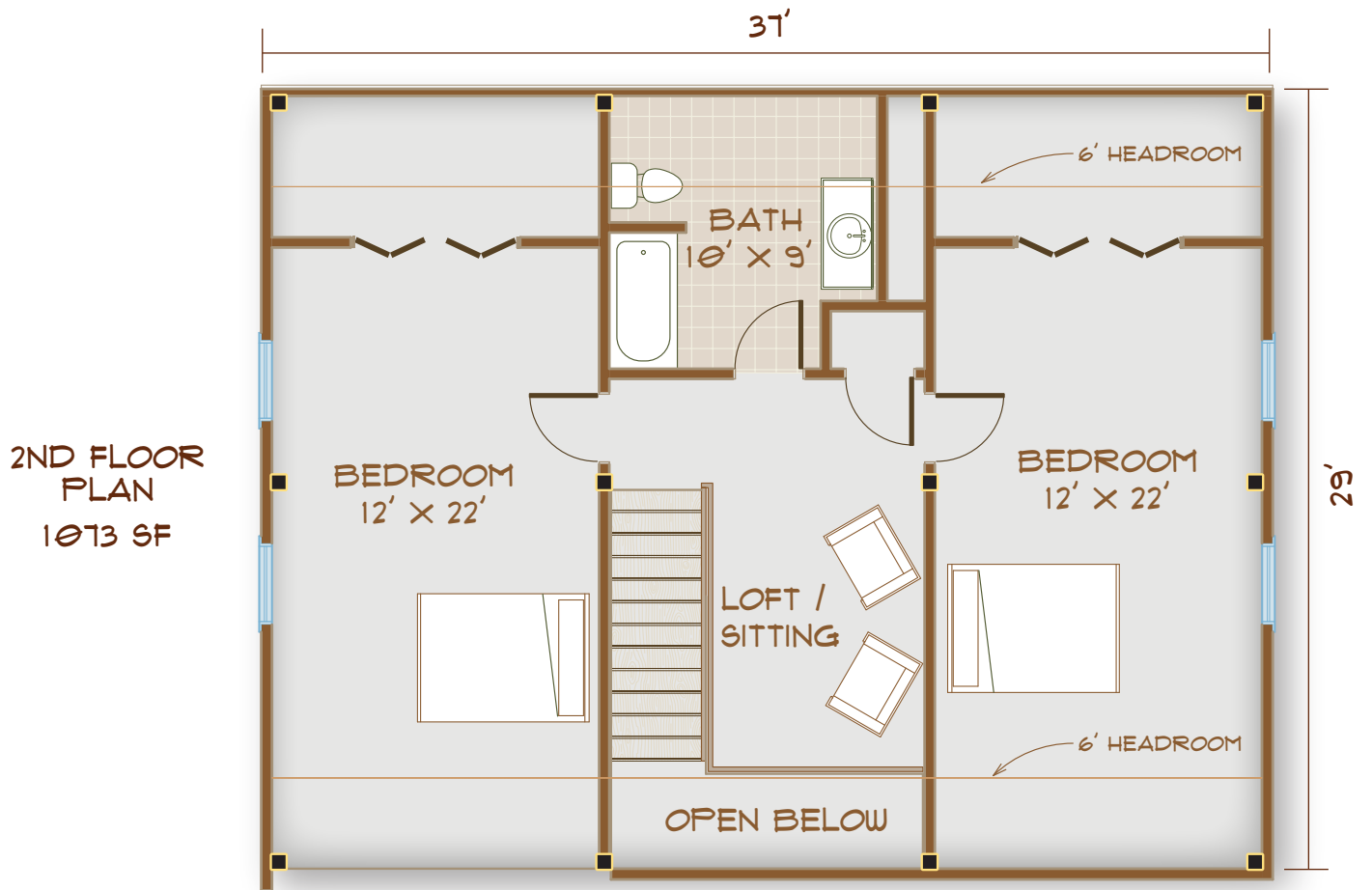

The Barrington



FRONT ELEVATION



**The Barrington:
Changing with
your times.**

603-654-3210 • 208 Pettingill Hill Road, Lyndeborough, NH

