

Haystack Barn

Utility at its most beautiful

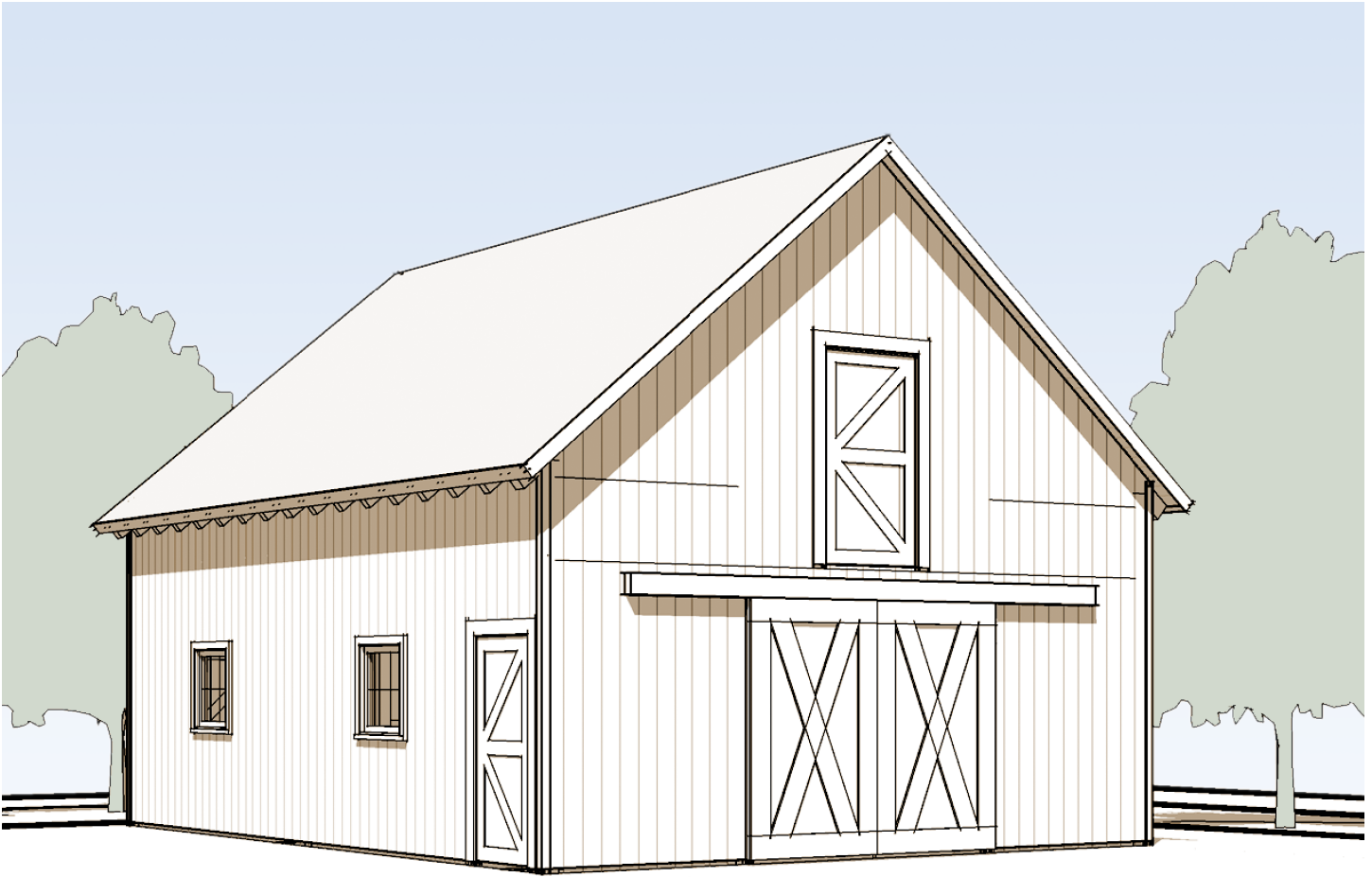

FRONT VIEW

The Haystack is a mid-sized 1-1/2 story barn or garage, with a full 2nd-floor loft. At 24' x 32', it is well suited to a smaller lot, but offers plenty of room above for storage, a workshop, or a play area. Rolling doors work well for equipment or mounted riders.

Timber frame barns are completely at home in a rural environment. They've been a part of the New England geography for centuries, after all! Brooks Post & Beam barns and garages are made primarily of native New Hampshire lumber; the walls can be composed of a simple, affordable layer of shiplap boards, just as they were 100 years ago!



www.brookspostandbeam.com

Haystack Barn

And while any timber frame structure will allow for flexibility, a barn can be even more versatile and responsive over time as your needs change.

Just move your partitions if you decide you want to turn your horse stalls into a parking area, apartment or art studio!

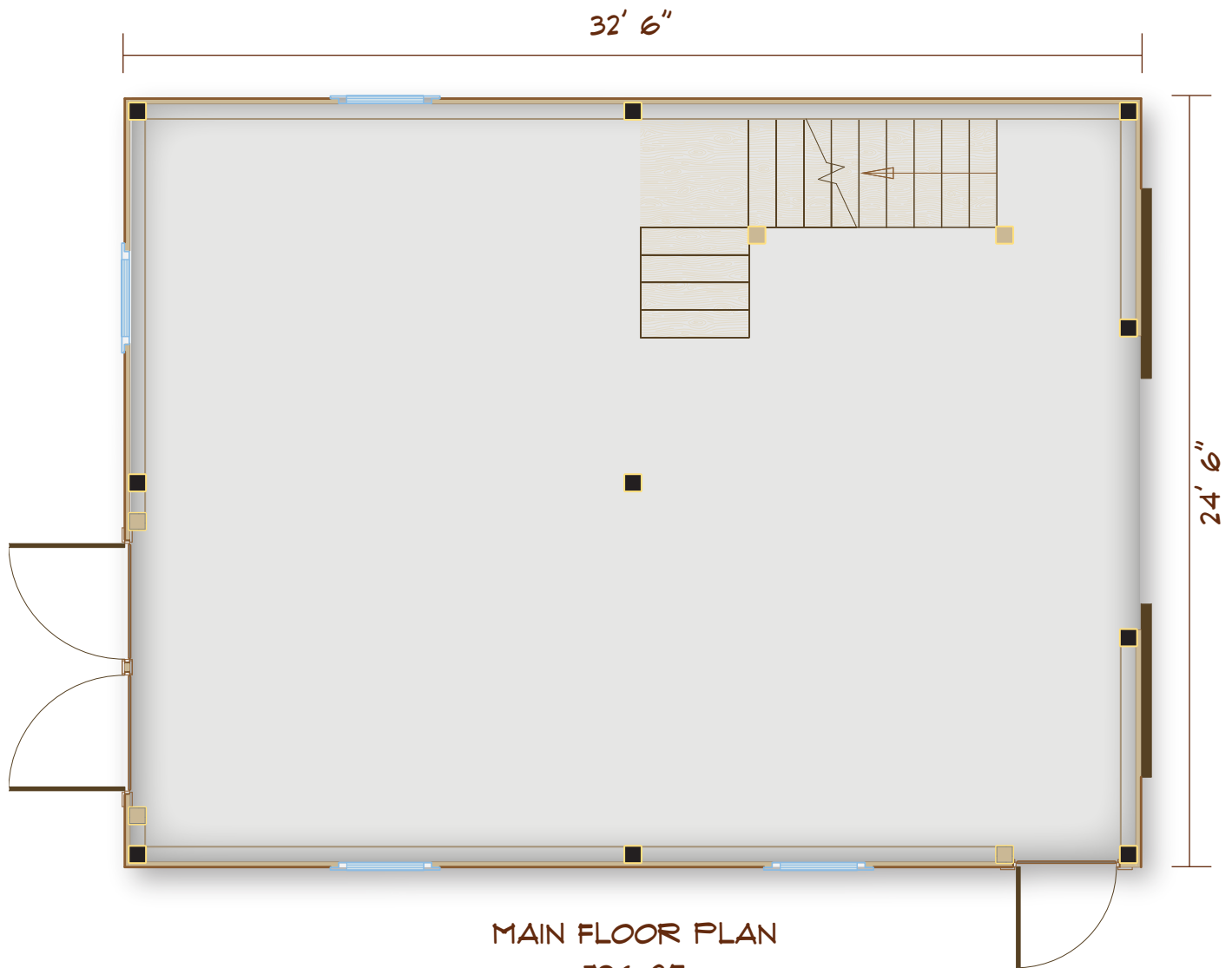

TOTAL SQUARE
FOOTAGE: 1592

Haystack Barn

UPPER
FLOOR PLAN
196 SF

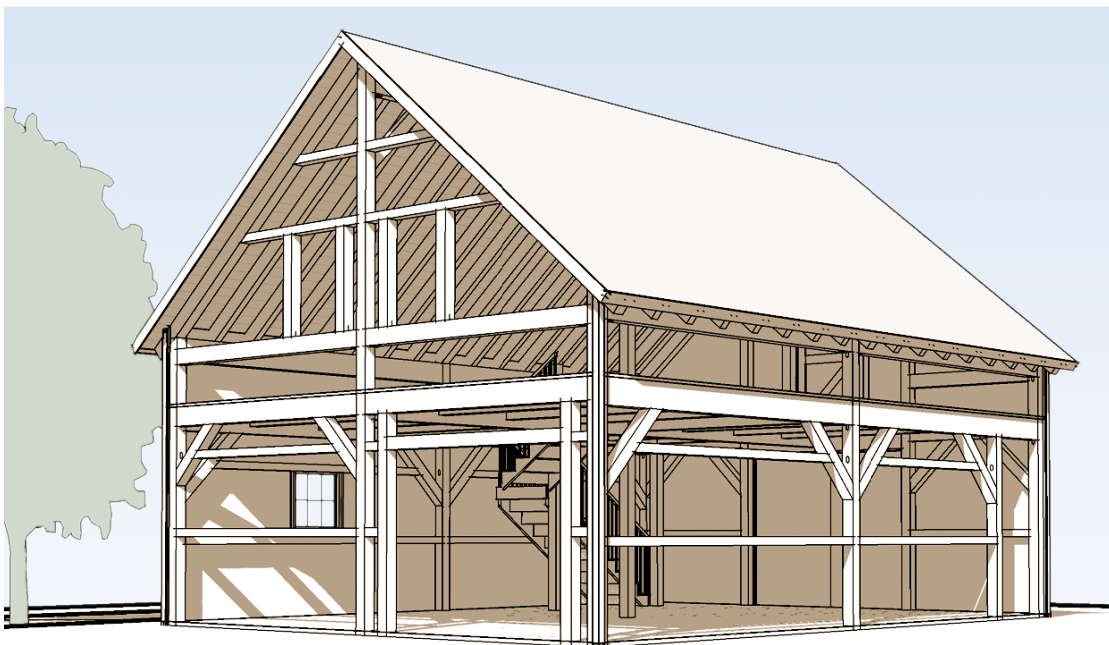
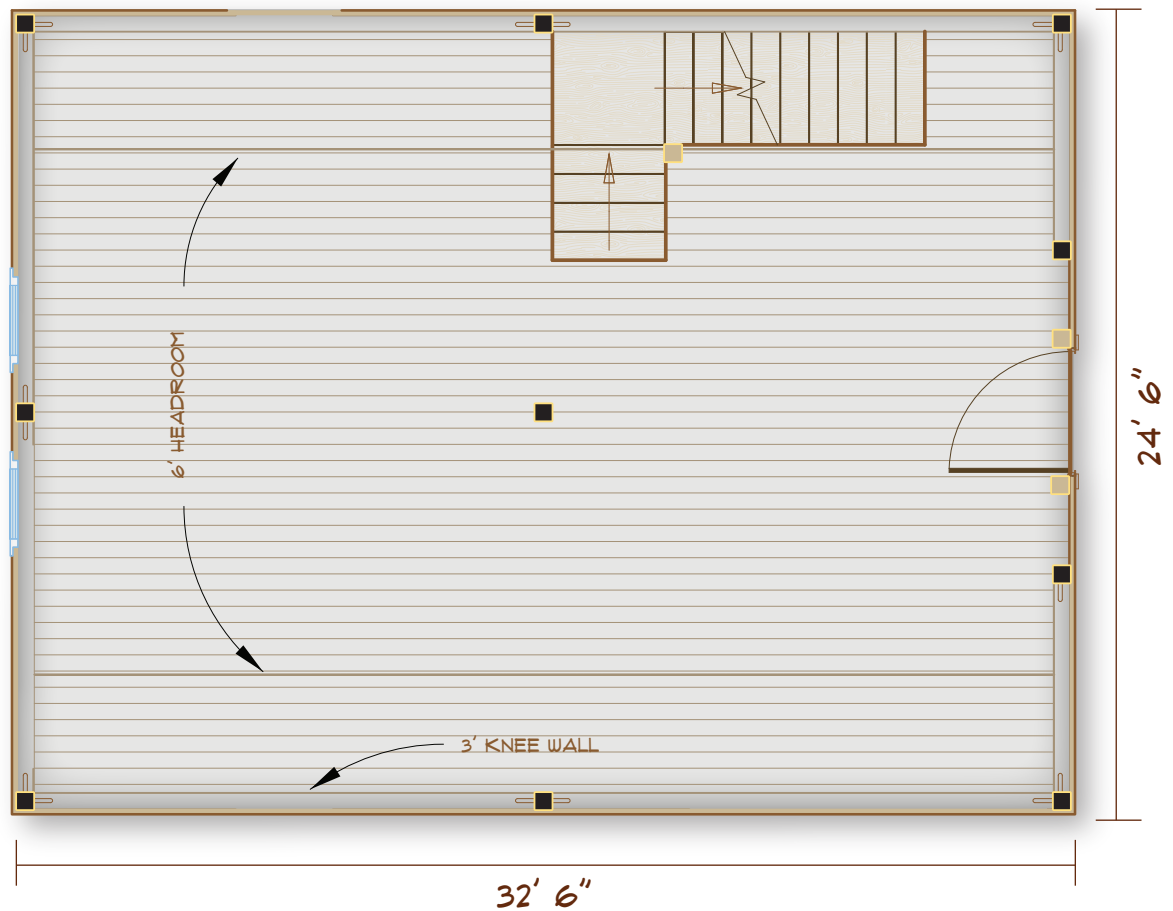

INTERIOR
FRAME VIEW



Haystack Barn

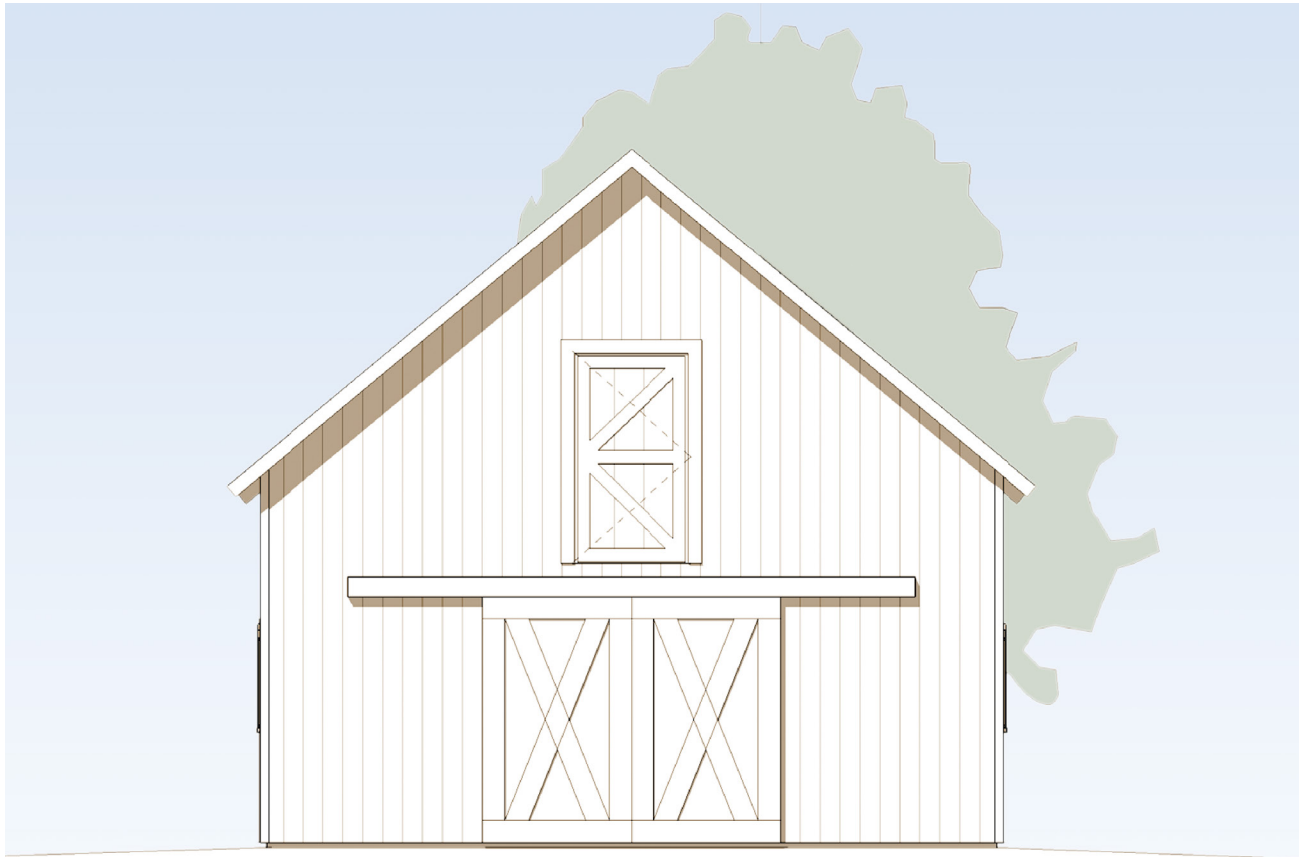

FRONT ELEVATION



Brooks
Post & Beam barns:
Where it all started.

603-654-3210 • 208 Pettingill Hill Road, Lyndeborough, NH

